

Casambi In-Wall Wireless Dimmer Switch

IMPORTANT SAFETY INSTRUCTIONS

READ ALL INSTRUCTIONS BEFORE INSTALLING FIXTURES. SAVE THESE INSTRUCTIONS.

Operating Temperature:
0°C to 55°C (32°F to 131°F)
Suitable for indoor use only.

Power Requirements:
This switch requires wired 120VAC power. Use this device with copper or copper clad wire only.

Safety:
For your safety, this device must be wired in accordance to local electrical codes and ordinances. All work should be done by a qualified electrician.

WARNING:
Make sure the power is **OFF** from the electrical panel before starting installation or attempting any maintenance.

Failure to install and wire device in accordance with the National Electrical Codes (NEC), all applicable Federal, State, and Local electrical codes, as well as specific UL safety standards for the intended working environment (location/application), may cause serious personal injury or property damage. Knowledge and expertise of electrical systems is required for installing this product. *When in doubt, contact a certified electrician.*

If you have any questions during your installation, please contact our Customer Support team at support@aspectled.com or give us a call at **888.503.1317**



Scan to Learn More About This Product



TOOLS YOU'LL NEED

#2 Phillips Head Screw Driver



Electrical Wire
use the right type and gauge suitable to connect your fixtures



Wire Stripper



PRODUCTS NEEDED FOR INSTALL

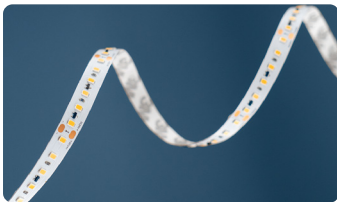

LED Light Fixture
Product will vary depending on Project Specifications



Casambi In-Wall Dimmer Switch
AL-CTRL-DIMSW-CAS



Non-Dimmable Power Supply
Product will vary depending on Project Specifications

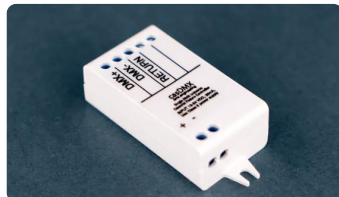

Controller
Example Shown: Casambi Controller

Safety First!

An easy way to remember the essential safety steps is by using the acronym **S.A.F.E.T.Y.** – a quick guide to stay safe and prepared.

- S:** Shut off the power
- A:** Ask a licensed electrician if needed
- F:** Follow NEC guidelines
- E:** Equip yourself with proper PPE
- T:** Treat the wires as live
- Y:** You are responsible

Set Up Your Casambi Network

Before installing this product, set up your Casambi Network. If you need assistance, refer to our complete setup guide by scanning the code or by visiting aspectled.com/casambi-app-installation-guide



Helpful Tips

This product is sized to fit a *standard single gang box* and requires a *wired connection*.

Input Power: 120VAC

Power Consumption: 50/60Hz | Max 1.5W

Average Range: 30ft (9.14m)

INSTALLATION INSTRUCTIONS

Determine the location.

Locate a spot where you'd like the device to be installed. Whether you're retrofitting into a previous switch setting or constructing a new spot, this switch will fit into a standard single gang box.

Wire the system.

Your device will have three connection holes with color coded screws. Match your ground wire to the green screw terminal, your white neutral wire to silver, and your black line wire to the black screw terminal. Be sure all screws are properly tightened before placing in the electrical enclosure.

Use this diagram below as a wiring reference. **When in doubt contact a licensed electrician.** Use the second poke hole to continue wiring to the next device if needed.

WIRING DIAGRAM

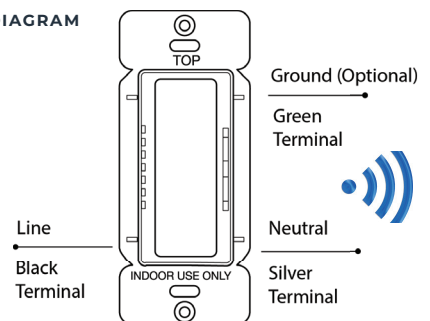

INSTALLATION INSTRUCTIONS

(CONTINUED)

- Carefully tuck the wires and switch body into the gang box.**
- Using the provided screws, affix the switch to the J-Box, use this diagram as a reference.**

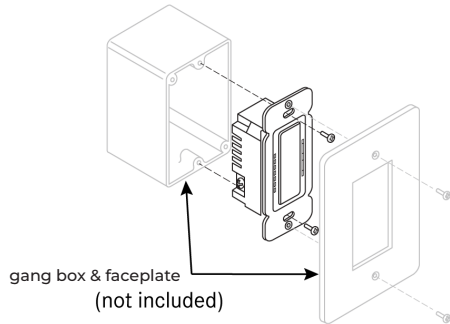

- Complete the install**
Assemble the decorative face plate (not included) over the switch and restore power from the Breaker Box to test the switch.

PAIRING THE SWITCH

- Turn on the switch and make sure it's ready to be paired.**
If the switch double-blinks every 1.5 seconds, it's functional and hasn't paired to your network yet.
If the light on the switch is steady, the device is paired and ready to be controlled.
If the switch is blinking on and off in 1 second intervals continuously, this means there is a communication error. If this happens, please give our experts a call and we can help you trouble shoot this issue.
- Open the Casambi App on your device.**
The app will automatically begin to search and find devices that are on and in Bluetooth range.
- Choose one of the pairing options.**
Choose **'Take all luminaires into use'** if you'd like to add the switch and any other new/unpaired devices to your default profile network

Choose **'Add individually'** to add luminaires and switches to specific networks that you've created
- Confirm your additions and test controls.**

DIMMER SWITCH INTEGRATION

- On the Home page, select the "More" tab in the bottom-right corner of the screen.**
- Select the "Switches" section and select the switch you'd like to configure.**
- Once in the menu, tap the 'Not in Use' option under Push Buttons and select what setup you'd like to control with the switch.**
- After selecting your lighting configuration, the 'Push Button' menu will update. Tap the new option that appears on the menu and select 'Done' in the top right of the screen.**
- You'll be brought back to the 'Push Button' menu. Select 'Done' one more time to confirm your configurations.**

PRO TIP!

If you want to control multiple luminaires in a room, add the individual luminaires to a group and pair your switch to your created group. For more information on creating a group, refer to the Casambi Installation Guide linked on the first page.

- Test & Check Your Lights**
Once you've configured your switch, test your light setup to make sure it's working properly.
Experiencing Issues? Give our team a call anytime from 7:30a - 5:30p CST, Monday-Friday or send us a message at sales@aspectLED.com
- That's it, you're all set!**
Nice work! You've completed the conventional installation process and your Casambi In-Wall Dimmer Switch is ready to go.

Share Your Work!

Thank you for choosing us for your project—we're thrilled to be a part of it! Share your finished projects with us on social media for a chance to be featured!



[f](#) [in](#) [@aspectLED](#)

For general information purposes only. Specifications, dimensions and construction not guaranteed and are subject to change without notice.