

Dimmable Power Supplies

IMPORTANT SAFETY INSTRUCTIONS

READ ALL INSTRUCTIONS BEFORE INSTALLING FIXTURES. SAVE THESE INSTRUCTIONS.

Safety:

For your safety, this power supply must be wired in accordance with the National Electrical Codes (NEC) and all local electrical codes and ordinances. All work should be done by a qualified electrician.

WARNING:

Make sure the power is **OFF** from the electrical panel before starting installation or attempting any maintenance.

Failure to install and wire power supplies in accordance with the National Electrical Codes (NEC), all applicable Federal, State, and Local electrical codes, as well as specific UL safety standards for the intended working environment (location/application), may cause serious personal injury or property damage. Knowledge and expertise of electrical systems is required for installing aspectLED Power Supplies.

When in doubt, contact a licensed electrician.

If you have any questions during your installation, please feel free to contact our Customer Support team at support@aspectled.com or give us a call at **888.503.1317**



Prefer to follow our online instructions?



TOOLS YOU'LL NEED

Screw Driver

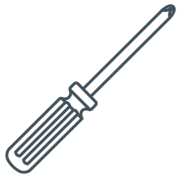

Wire Stripper



Power Drill
*optional

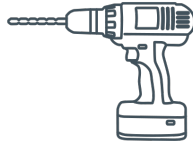

BEFORE YOU BEGIN

Location of Installation

Power supplies need to be installed in an accessible location for potential servicing or future replacement. They cannot be sealed in a wall or an inaccessible location per electrical code. If the power supply has exposed wire connections, it should be in a metal junction box. We have a range of junction box options available on our dimmable power-supplies page.

Suitable Use

The power supply is not submersible and is not suitable for wet location use.

Installing in Damp Locations

When using the power supply in exterior damp locations, it must be installed where it is protected from rain or other moisture by installing in a weatherproof electrical enclosure.

BEFORE YOU BEGIN

(Continued)

Load Capacity

Keep in mind the load capacity of the power supply. Typically, the power supply will perform best when it is loaded at 60-80 percent of its capacity. Load capacity may vary from power supply to power supply, check the specifications for your application.

Dimmer Switch Compatibility

Make sure that the dimmer switch is compatible with the power supply. You can view our compatibility chart on our website, located in the drop down description of your respective product's page.

IMPORTANT!

Dimmer Switch Overload

DO NOT overload the dimmer switch. Switches also have load specifications, typically rated in either amps or watts that need to be followed. Some dimmers also have a minimum load range.

Multiple Power Supplies

DO NOT combine multiple power supplies on the same dimmer switch.
(One exception: you may have multiple power supplies on the same dimmer if it is a 0-10 dimming circuit.)

Mismatching Load Types

DO NOT mismatch load types, such as strip lights and recessed lights. Strip lights and recessed lights should each have a dedicated circuit.

PRO TIP!

If you are putting the power supply on a dimmable outlet, you can label the outlet as being on a dimmer with a label maker and **orient the outlet upside down to indicate the outlet is on a dimmer.** Not everything can be on a dimmer and details like this will make the installation more user friendly and professional!

Share Your Work!

Thank you for choosing us for your project—we're thrilled to be a part of it! Share your finished projects with us on social media for a chance to be featured!



@aspectLED

Continue to installation instructions on next side. →

INSTALLATION INSTRUCTIONS



Determine Your Locations

Determine a suitable location for installing your power supply, LED Light Fixture, Dimmer Switch & Wire.

Note: Be sure to choose the right wire for the specific application. Your choice of wire will depend on voltage drop, amperage rating, and environment. To check your wire size, consult the NEC code's voltage drop and wire sizing chart.

Using the incorrect wire size will damage your products! When installing wire in a wall or ceiling, always use in-wall rated wiring.



Mount Your Power Supply

Using the mounting holes on the power supply, fasten the driver to a sturdy surface in the desired orientation using appropriate screws and a Phillips or flathead screwdriver. Ensure you leave a 3" air gap on all sides of the power supply besides the side that is mounted so your power supply has adequate airflow.



Make Your Low Voltage Connections

Connect the LED light fixtures to the output of the power supply. **DO NOT install different LED fixture types on the same power supply as flickering and faulty dimming may occur.** Before reconnecting power at the fuse or circuit breaker, install any additional components and verify all connections.



Connect the Power Supply to Line Voltage

The power supply can either be plugged in or hard wired. For hardwiring, consult the wiring diagram included with the dimmer switch for specific dimmer instructions.



Double Check and Power Up

When finished, please double check all of your connections and turn on the power to the circuit. Then test the functionality of the installation to make sure it works properly.

If there are any issues, please see the trouble shooting section of the online install guide linked to the QR code on the front page of this guide, or contact aspectLED technical support at (888)503-1317 {option 3} or by email at support@aspectled.com.



That's it, you're all set!

Nice work!

Once the power supply is securely installed and setup with your light fixture, your lighting system is ready to use.

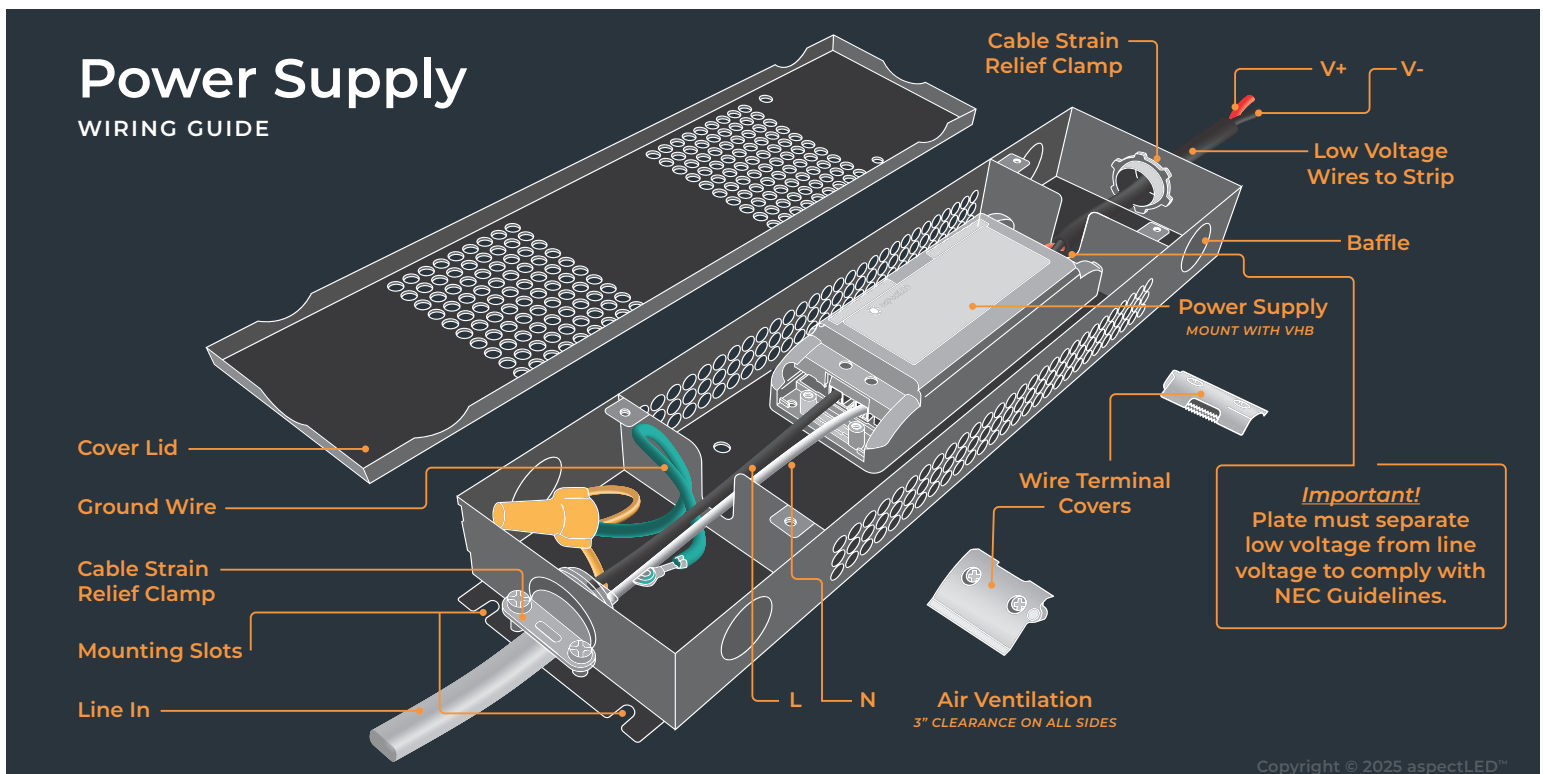

For general information purposes only. Specifications, dimensions and construction not guaranteed and are subject to change without notice.