

ADJUSTABLE WHITE ULTRA-THIN RECESSED LIGHT



IMPORTANT: Read all instructions before installing the fixtures. Retain instructions for future reference.

OPERATING TEMPERATURE:
-4°F to 113°F (-20°C to 45°C)

Suitable for damp locations. **For indoor installation only.** Suitable for insulated and non-insulated ceilings. Air tight. Type IC Rated for direct contact with insulation.

SAFETY:
For your safety, this fixture must be wired in accordance with local electrical codes and ordinances. All work should be done by a qualified electrician.

WARNING:
Make sure the power is OFF from the electrical panel before starting installation or attempting any maintenance. For indoor installation only.

Failure to install and wire fixture or install replacement power supply in accordance with the National Electrical Codes (NEC), all applicable Federal, State, and Local electrical codes, as well as specific UL safety standards for the intended working environment (location/application), may cause serious personal injury, or property damage. aspectLED Adjustable White Ultra-Thin installation requires knowledge of light's electrical systems. If not qualified, do not attempt installation. Contact a qualified electrician. Do not alter, relocate or remove the wiring, junction box, power supply, or any other electrical components. Risk of fire or electrical shock. To prevent electrical shock, please wear rubber shoes and work gloves when installing the aspectLED Adjustable White Ultra-Thin. 5 years warranty is limited to the repair or replacement of defective lights. Damages caused by abuse or misuse are not covered in aspectLED's Warranty.

TOOLS YOU'LL NEED

Sheetrock Jab Saw



Tape Measure



Wire Stripper



Screw Driver



Electrical Wire
(use the right type and gauge suitable to connect to the fixtures)



Drill with Hole Saw
(optional)

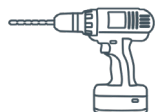

Prefer an installation video? Check out our installation guide video by scanning the QR code on the front.

We're here to help you. For further assistance, contact aspectLED Technical Support at (888) 503-1317.

ASSEMBLY INSTRUCTIONS

1 Turn off power before installing, inspecting or removing your fixture.

2 Lay out the light locations on the ceiling.

Using a tape measure and the layout/grid design that you've decided on, lay out the location of each light on your ceiling and mark the center of each light location with a small pencil mark. The old adage of measuring twice and cutting once is worth thinking about as you're marking your light locations. No one wants to repair or patch a ceiling because they cut their hole in the wrong spot.

3 Cut the hole in accordance with the cut-hole dimension in the table below.

CUT-OUT SIZES

- 3.25" Round:** 2-3/4" diameter (70mm)
- 4.75" Round:** 4-3/8" diameter (110mm)
- 6.5" Round:** 6-1/8" diameter (155mm)
- 8.75" Round:** 8" Cutout Hole Diameter (205mm)
- 4.75" Square:** 4-3/8" length + width (110mm)
- 6.5" Square:** 6-1/8" length + width (155mm)

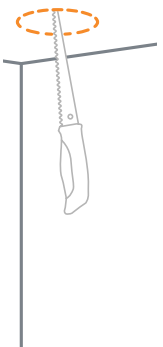

4 Run wire to the Driver and make connections.

In accordance with NEC and/or your local electrical code, run the 120VAC electrical wire from the switch/dimmer location to the location where you will install the LED driver at the light fixture. Use supply wire rated for 90°C or greater. Be sure to check the local code for which type of wire to run, most electrical codes require NM (also called Romex), BX, or MC wire.

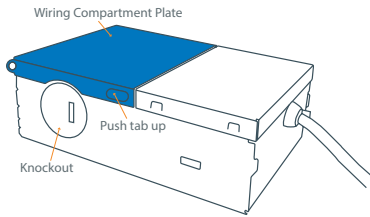

Open wiring compartment plate.

5 Open the swing cover on the driver box and remove the appropriate knockout(s).

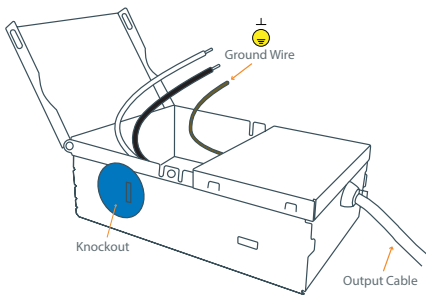

Remove knock-out(s) as needed to run supply wiring into wiring compartment.

6 Insert the electrical supply cable through the knockout(s).

7 Wire the driver box using the supplied quick connect push-in terminals.

- Connect the ground cable wire to green driver box wire
- Connect the white cable wire to white driver box wire (neutral)
- Connect the black cable wire to black driver box wire

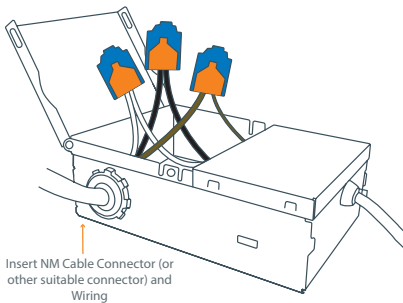

Make supply connections to driver supply wires and ground wire lead using supplied wire connectors.

KNOCKOUT CLAMP WHERE REQUIRED BY CODE.

8 Place all the wires and connections back into the driver box and close the cover.

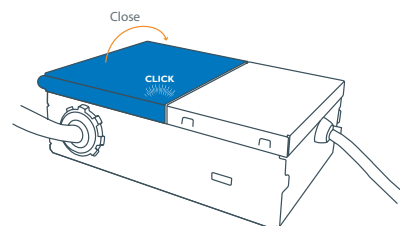

Install wiring compartment cover and snap shut.

9 Connect the LED Driver to the light.

Verify that the input voltage of the LED driver matches the source voltage. Verify that the output voltage and current of the LED driver match the input voltage and current of the light. Connect the driver cable plug to the plug on the light. Pay close attention to the arrows on each plug. These arrows must point towards each other. Screw the connectors together. It is important to remember that each size light requires its own specific driver.

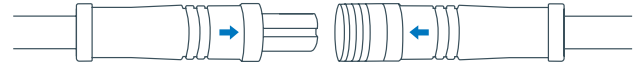

10 Place the LED Driver through the hole.

Carefully place the LED Driver up through the hole. If driver must be attached to structure per code, use screws or other removable fastener to fasten unit using keyholes provided. It is very important that the LED driver remains accessible by removing the light, thus allowing you to inspect the connections or LED driver at any time without physically damaging your ceiling or other building materials. Mount your LED driver in a dry location, unless otherwise marked. For some smaller recessed fixtures, our driver may not fit through the fixture's cut-out hole. In this case, you will need access from above the ceiling or behind the wall, or you may remotely locate the driver and run class 2 low voltage wire between the driver and the light. In the event that you remotely locate the LED driver, only use aspectLED class 2 low voltage extension cables between light and LED driver, and never connect multiple extension cables together.

11 Install the light into the cut-out hole.

After you have verified that the light cord is connected to the driver output cord, gently lift upwards on the retention clips on each side of the light fixture and carefully push it into the cut-out hole. Once the light fixture is in the hole, allow the spring-loaded retention clips to come down, holding the light firmly in place against the drywall or ceiling material. Do not install this light into ceiling material with a thickness over 1".

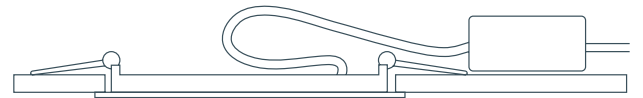

12 That's it! You're finished!

Congratulations! You've successfully completed the conventional installation process. Once the light is installed into the ceiling, your project is finished. Now is a great time to take a moment to sit down and enjoy your favorite beverage while giving yourself a pat on the back for a job well done. If you ever need to remove the light in order to access your junction box (or anything in the ceiling cavity above), simply grab hold of the sides of the light and gently pull downwards until the light comes about 1/2" down out of the hole. Before pulling the light all of the way out of the hole, be sure to get a firm grip on the retention clips, so you can hold them upwards in order to avoid getting your fingers snapped in the springs. Then pull the light the rest of the way out of the hole and gently let the retention clips back down. **Remember, the retention clips have a similar strength to your average mousetrap! Be careful not to snap your fingers inside of the springs!**