



# Wireless RGBW Multi-Zone LED Handheld Remote Controller

## AL-CTLR-RGBW-4ZRF-RMT

**IMPORTANT: Read All Instructions Prior to Installation**

### Product Data

Output	RF Signal
Operation Frequency	869.5/916.5/434MHz
Power Supply	4.5V (3xAAA Battery)
Operating Temp.	0 – 40°C
Relative Humidity	8% to 80%
Dimensions	120mm X 55mm X 17mm
Waterproof Grade	IP20 Non-Waterproof

### Safety Warning

This device contains AAA batteries that must be stored and disposed of properly. Follow local guidelines for battery disposal or recycling. **DO NOT expose this device to moisture.**

### Device Features

- Control 4 zones of RF receivers separately
- RGBW Color Controller
- Highly sensitive, stable, fast, & precise color control
- Compatible with all universal series RF receivers
- 1 receiver can be paired by max. 8 different remote controls

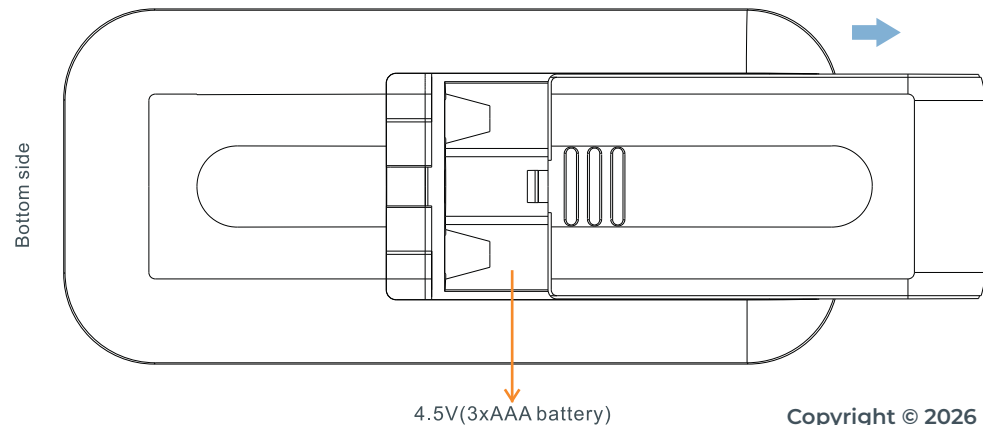
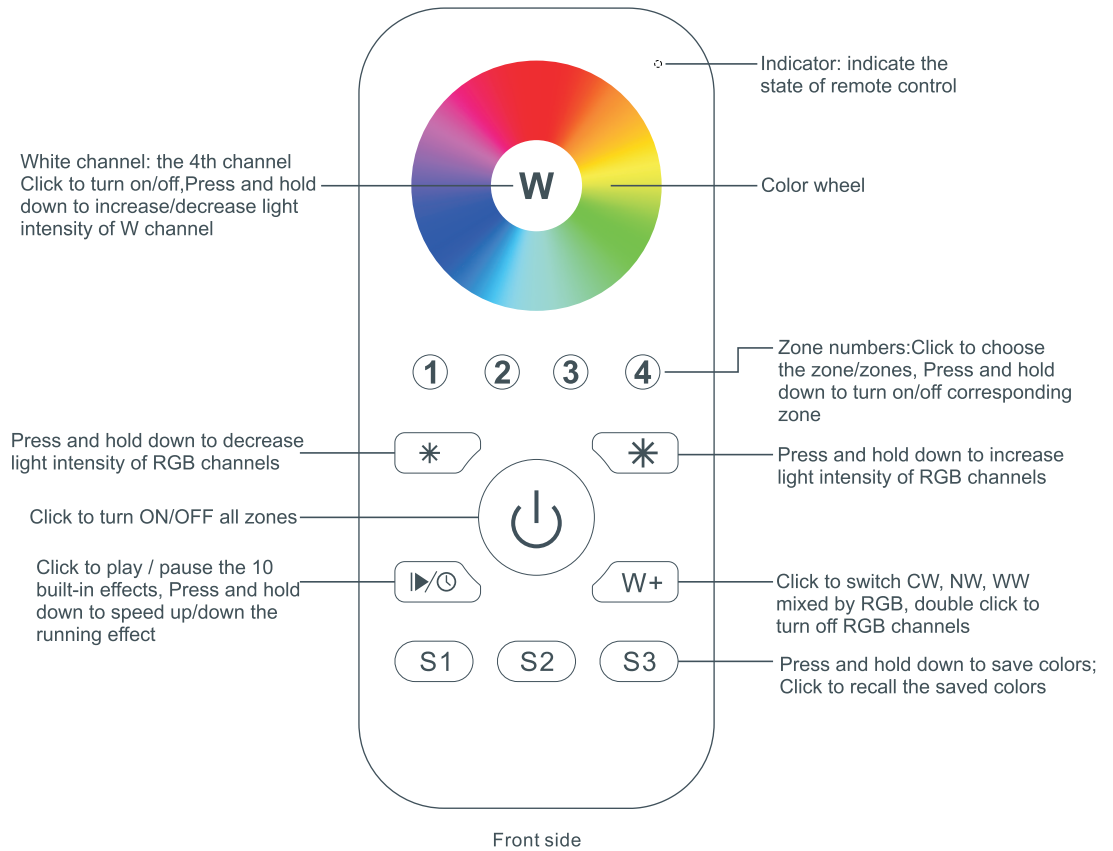

### Pair with RF receiver (Method 1)

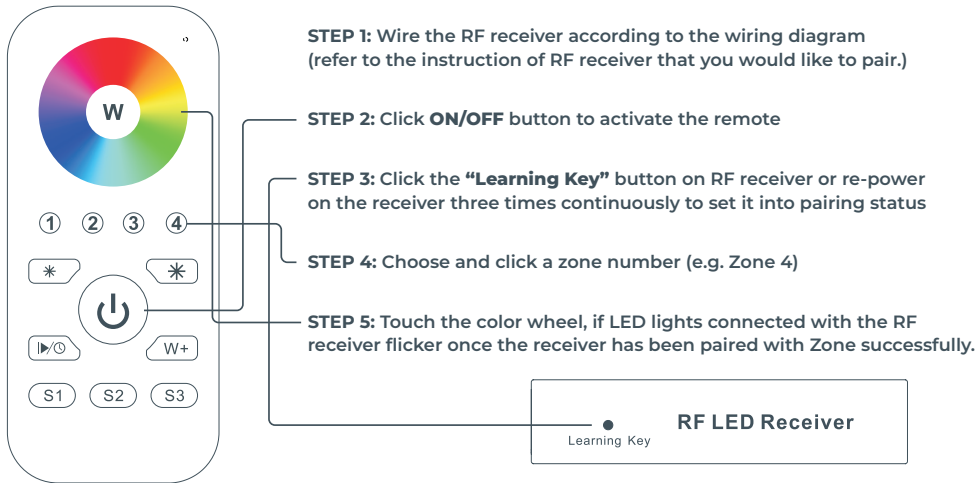

### Save Color/Scene/Mode

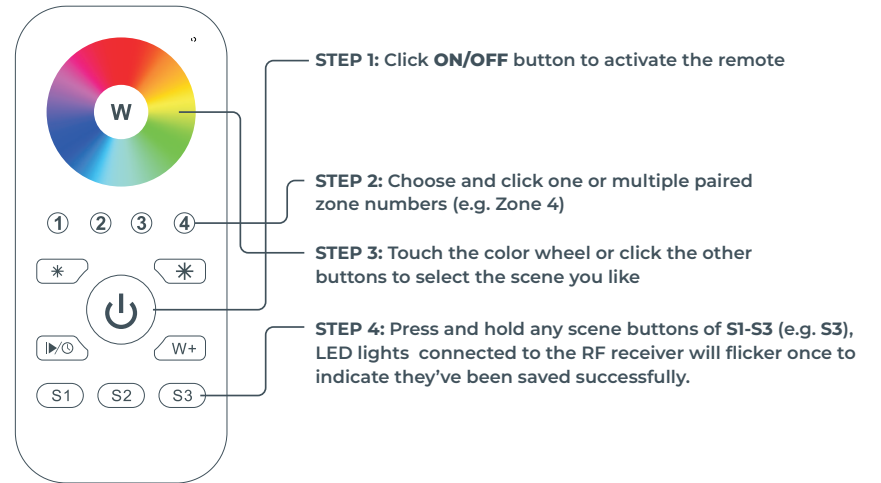

### Pair with RF receiver (Method 2)

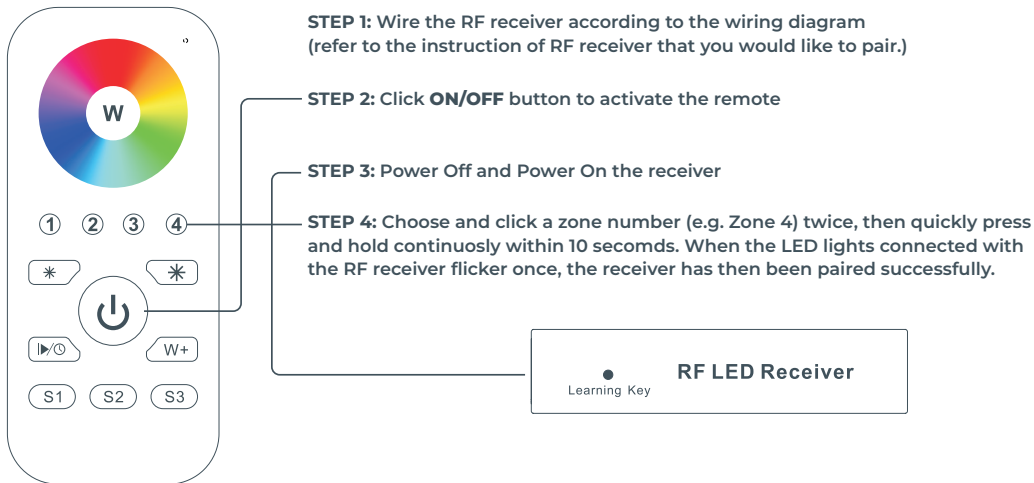

### Recall the Saved Colors/Scenes

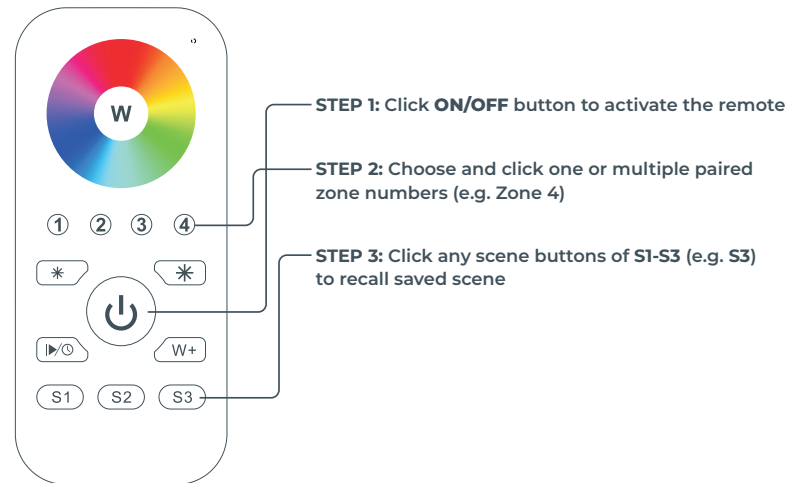

**If you use multiple receivers, you have two options:**

Option 1: Have all the receivers in the same zone



Zone 1



RF remote

Option 2: Have each receiver in a different zone



Zone 1



Zone 2



Zone 3



RF remote

**Built-in 10 color changing modes are as follows:**

Mode 1: Any two colors of RGB mix fade-in & fade-out

Mode 2: RGB three colors mix fade-in & fade-out

Mode 3: RGB three colors mix fade-out & fade-in

Mode 4: RGB flash

Mode 5: RGB three colors fade-in & fade-out successively

Mode 6: RGB three colors fade-in successively

Mode 7: RGB three colors fade-out successively

Mode 8: RGB three colors jump changing successively

Mode 9: R&B two colors mix fade (R in B out), then G fade-in, then R&B mix fade (R out B in), then G fade-out

Mode 10: B fade-out, then G&B mix fade (G out B in), then R&G mix fade (R out G in), then R fade-in

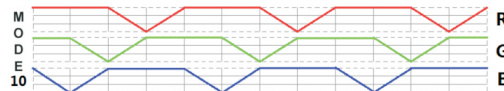
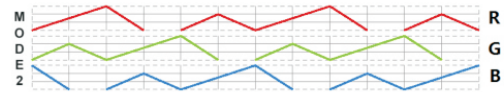
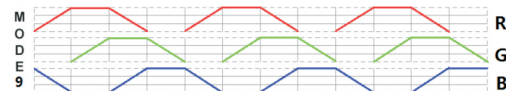
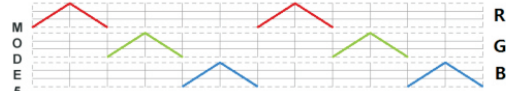
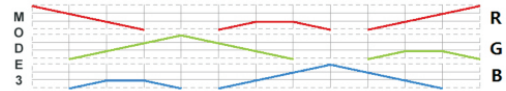

**How to stop running mode of single color LED light caused by RGBW sender interference:**

When pairing a single-color LED light to a single-color remote, nearby RGBW transmitters may interfere and inadvertently pair with the receiver, causing the light to enter a running mode that cannot be stopped by the original single-color remote, even after deleting the pairing.

To resolve this, pair this remote to the affected receiver using Pair with RF Receiver (Method 2), then tap the color wheel to exit running mode. Finally, delete the pairing and re-pair the receiver to the single-color remote as normal. The light will now respond correctly to its intended remote.